



WISESCENE DIMMING

LED STRIP - part code: WISESCENE STRIP

SIMPLE INSTRUCTIONS

Led Dimmer, 12VDC and 24VDC LEDs

WARNING 12/24V INPUT

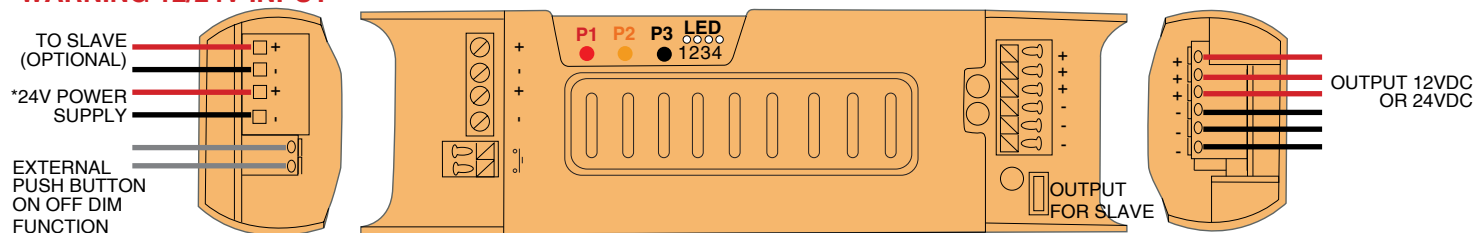

Button P1 = Test Button

1. Testing Press to test circuit for on/off. Hold to dim

Button P2 = Program Button

1. Scene Press 1 time to program a 7 button switch for scene control
2. Dimming Press 2 times to program a 1 button for on/off and dimming
3. Switch ON only Press 3 times to program a 1 button switch for ON
4. Switch OFF only Press 4 times to program a 1 button switch for OFF

Button P3 = Delete Button

1. Delete Buttons Press 1 time to delete a 1 button or 7 button switch
2. Delete All Memory Press 2 times to delete all memory

Pack Specification

Power Supply	24V DC
Min load	1W
Max load 24V DC	300W
Max load 12V DC	150W
Max Switches per Pack	16
Max Scenes per Pack	64
Max Addresses	20
Radio Frequency	868.3 MHz
Height	35mm
Weight	47mm
Length	165mm
Min spacing between packs	200mm
Range for Plastic Switch	100m Max line of sight*
Range for Metal	50m Max line of sight*
	*(subject to installation)

Combinations

- Button **P1 + P3** Activation or Deactivation of memory (when programmed to 'dimming')
- Button **P1 + P2** Setting Address number number (1-20) Press **P3** to increase Address number.
Press **P1** to confirm Address number

LED Indication

- LED1 ON= Indicates a malfunction
- LED2 Flashing = Receiving of radio signal & setting Address / ON = Address setting mode
- LED3 Flashing = Address number confirmation, signifies individual units 1-9, e.g 7 flashes = Address 7
- LED4 Flashing = Address number confirmation, signifies units in tens, e.g 1 flash = Address 10
ON = Light memory On

Wiring Packs

Please ensure the WISESCENE STRIP is connected to a 12V/24V power supply. Connect the 12V or 24V LED strip to the output terminals, making sure the correct polarities are followed. Press **P1** to test wiring is correct.

How would you like to program the pack?

Option A : Scene Programming - Using a 7 button switch gives you 4 scene, raise, lower and OFF. Gives you the flexibility to create different atmospheres in your house, controlling multiple circuits on one button. You can store different scenes on your Wise Switches for whatever occasion.

Option B : Dimming Programming - Allows circuits to be switched ON/OFF or dimmed from a single button, or raise, lower and ON/OFF with three buttons.

Option C : Switching ON only Programming - Allows you to switch single or multiple circuits ON. Ideal for programming a 'Master ON' switch to turn on certain circuits as you enter your home.

Option D : Switching OFF only Programming - Allows you to switch single or multiple circuits OFF. Ideal for programming a Master OFF button for your home.

Option E : Deleting - To delete switches or remotes from the packs.

A pack is not limited to one of the programming options. e.g you can program a switch for scene control, another switch for dimming and another switch for master ON/OFF.

7 Button Switches - ID Switch, Wise Style Switch and Wise Pod

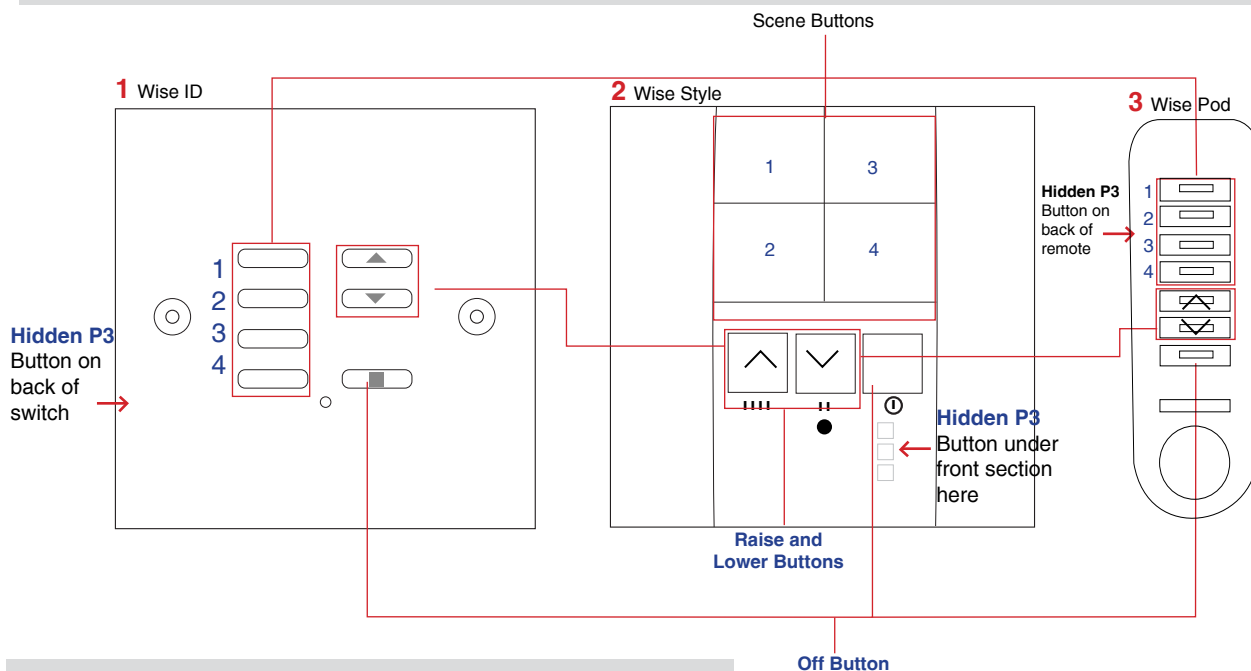

Option A - Scene Programming

Part 1 - Address Programming

Each pack programmed to the same switch should have a different Address number.

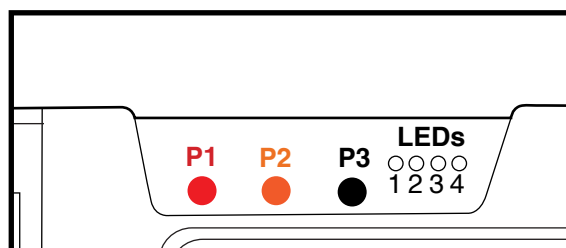

1A - Setting the Address Number

1. Press **P1** + **P2** together to enter Address setting, LED2 turns on. Default is 1 Flash from LED3 for Address number 1. Wait for the flashing to finish.
2. Press **P3** 1-20 times to set the Address number, (LED2 flashes after each press) the amount of times you press **P3** will be the Address number. (If you lose count or want to reset the Address number press **P2** at this stage, then repeat step 2 again).
3. Press **P1** to confirm the Address and exit Address programming.
4. Repeat steps 1-3 for all packs. Each pack programmed to the same switch should have a different Address number.

To check what Address number a pack has been set to press **P1** + **P2**. LEDs 3 + 4 will flash to confirm the Address number. For example, if the Address number was 14, LED4 will flash 1 time and LED3 will flash 4 times, making 14. Press **P1** to exit Address programming.

1B - Programming the switch to the packs

1. Press **P2** and hold, you will hear a continuous beep. Press button 1 on the seven button switch at the same time, you will hear an intermittent beep to confirm programming.
2. The 7 button switch will now automatically be programmed with the default scenes, as follows, Scene 1=100%, Scene 2=75%, Scene 3=50%, Scene 4=minimum, Raise, Lower and OFF. To program personalised scenes, see Part 2.
3. Repeat step 1 for all packs that require programming to the switch.

Part 2 - Scene Programming

2A - Programming the Scenes

1. To enter programming mode, press and hold **Scene button 1** for 5 seconds, wait until you hear a beep and the lights flash, now you are in programming mode.
2. To select which pack to program, use the raise button to move up through the packs, use the lower button to go back down through the packs (if you are already on the pack you wish to program, press the **lower button** then the **raise button** to re-select the same pack). To show which pack is selected the lights wired to that pack will turn off. If the pack is already off the

lights will flash on then off. (Selecting the pack relates to the Address number given to the pack in section 1A, e.g if you press the **raise button** 3 times you will select pack 3 with address 3).

3. Select the scene button you want to program for that pack, by pressing **Scene buttons 1,2,3 or 4**.

4. Use the **raise and lower buttons** to choose the dimming level. If you want the pack to be programmed to OFF press **Scene button 1**. For the Wise scene switching pack press **Scene button 1** once for choosing OFF, press twice for Unaffected (will flash on then off)/ and press three times for ON.

Repeat steps 2-5 until all packs and scenes are programmed. Press OFF to save and exit.

2B - Programming another switch for 2 way with the same scenes

1. Press **Hidden P3** button on the 7 button switch already programmed.
2. Press **button 1** on the same 7 button switch, within 5 seconds.
3. Press **button 1** on the new 7 button switch that is requiring 2 way programming, within 5 seconds.

This copies the programmed scenes. You can then adjust the scenes on the new switch if required. 16 switches can be programmed to each pack. This gives a maximum 64 scenes.

2C - Programming another switch for 2 way with the default scenes.

Follow the steps in section **Part 1, 1B**. The switch will then have the default scenes.

Option B - Dimming Programming

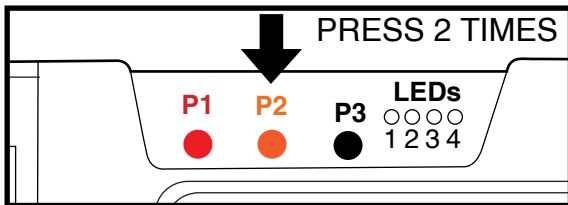

1. Press **P2** twice within 2 seconds and hold on the second press, you will hear a continuous beeping sound.
2. Press the button that is to be programmed Simultaneously, you will hear an intermitting beep to confirm the button is programmed. This will program your switch to the pack. Press the switch to turn the light on/off (<800ms). Hold the switch to dim the light to the required level (>800ms).

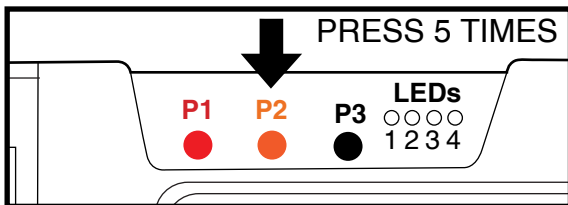
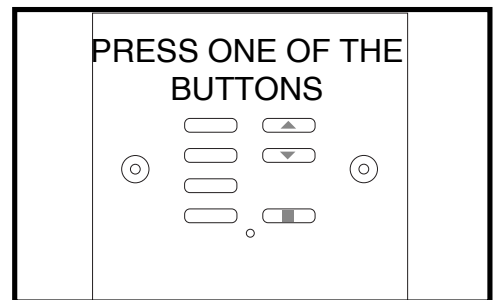

1. Press **P2** five times within 5 seconds and hold on the fifth press, you will hear a continuous beeping sound.
2. Press one button on the three button switch at the same time, you will hear an intermitting beep to confirm programming. The 3 button switch will now automatically be programmed with Raise, Lower and ON/OFF function.

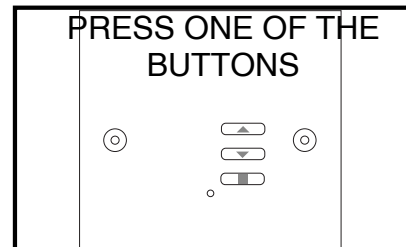

The light memory function can be turned ON or OFF (default setting) by pressing **P1 + P3** (LED4 on the pack will turn on when the function is on). With this function ON the light will turn on at the last brightness level set. With this function OFF the light will turn on at 100% brightness.

Option C - Switch ON Only Programming

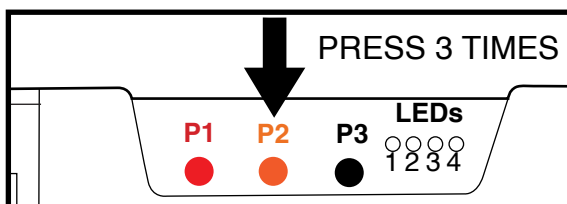

1. Press **P2** three times within 3 seconds and hold on the third press, you will hear a continuous beep.
2. Press the button that is to be programmed Simultaneously, you will hear an intermitting beep to confirm the button is programmed. This will program the button to work as ON only. Light memory being ON or OFF will affect the function.

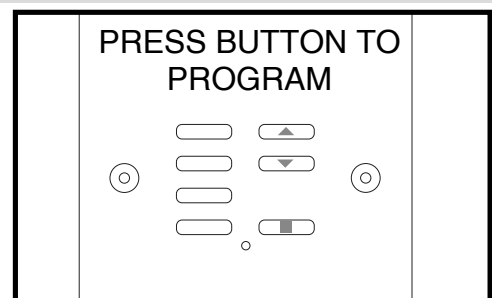

Press the switch to turn the lights ON only. There is no limit to how many packs you program to the switch. Can be used at the entrance of the house to turn on chosen circuits.

Option D - Switch OFF Only Programming

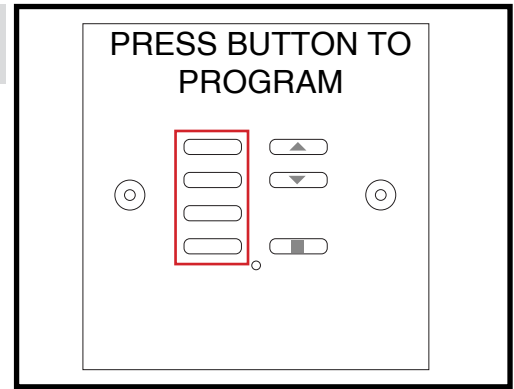
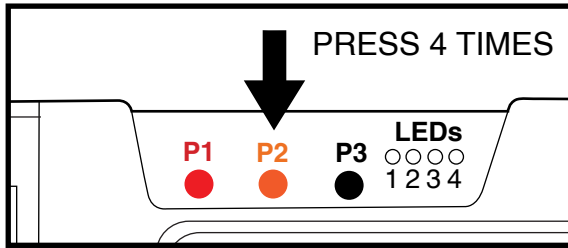

1. Press **P2** four times within 4 seconds and hold on the fourth press, you will hear a continuous beep.
2. Press the button that is to be programmed Simultaneously, you will hear an intermitting beep to confirm the button is programmed. This will program the button to work as OFF only.

Press the switch to turn the lights OFF only. There is no limit to how many packs you program to the switch. Can be used at the entrance of the house to turn off chosen circuits. This makes a convenient Master OFF switch.

Option E - Deleting

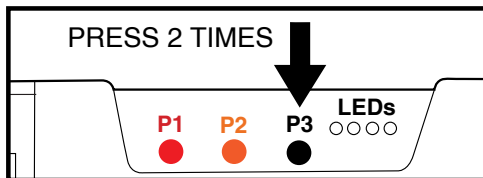

1 - Deleting All Memory

1. Press **P3** twice within 2 seconds. Hold down on the second press for 10 seconds, until the sound changes from fast intermitting beeping to a continuous beep.

2 - Deleting Dimming or Switching Button

Press **P3** and hold, you will hear a slow intermitting beep. Simultaneously press the button you wish to delete, you will here a continuous beep to confirm the button is deleted.

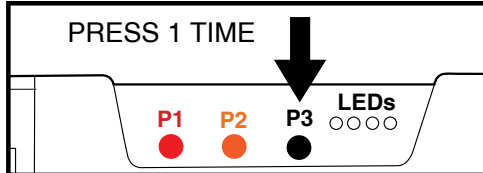
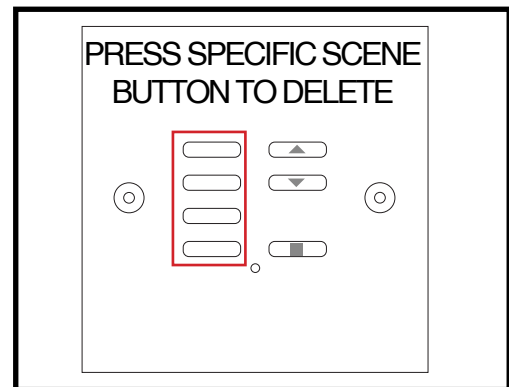

3 - Deleting Scene Buttons

Deleting a scene button results in deleting all other buttons on that switch, requiring you to set the scenes again. Press **P3** and hold you will hear a slow intermitting beep. Press **button 1** on the seven button switch Simultaneously, you will here a continuous beep to confirm.

4 - Deleting Buttons Using The Hidden P3 Button on Switch

You will find the **hidden P3** button at the back of switch **1** and switch **3** and underneath the front casing on switch **2**.

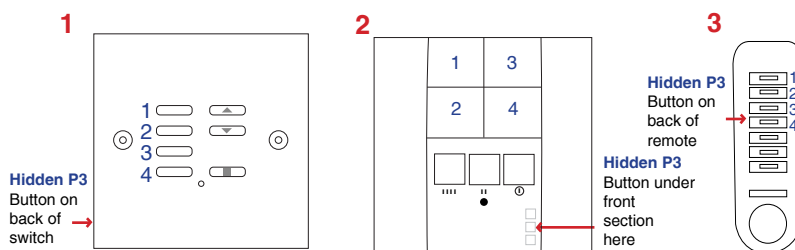

1. For individually programmed buttons, e.g dimming or switching - Press the **hidden P3 button** on the switch 3 times within 3 seconds then select the button you wish to delete.
2. For Scene set programmed buttons - Press the **hidden P3 button** on the switch 3 times, within 3 seconds, then press **button 1** on the 7 button switch, this will delete all programmed buttons.

Attention

The subject appliance must be installed only by qualified technical personnel in compliance with the standards. All connections must be rated for a single-phase power supply of 230V. For the disconnection from the power line, use an all-pole switch with contact with an opening of at least 3,5mm. Only suitable materials for the connections must be used to guarantee insulation that complies with current standards on the subject of electrical safety. All the necessary safety devices are to be seen to separately.

In the view of a constant development of their products, the manufacturer reserves the right for changing technical data and features without prior notice.